

STATE OF SOUTH CAROLINA)

COUNTY OF BEAUFORT)

TOWN OF YEMASSEE)

ORDINANCE NUMBER:)

(22-04)

An Ordinance Annexing One Parcel of Land owned by Grandville Clark into the Town of Yemassee, South Carolina.
--

AN ORDINANCE ANNEXING INTO THE TOWN OF YEMASSEE, ONE PARCEL OF LAND OF APPROXIMATELY 4.07 ACRES, LOCATED AT 133 TRASK PARKWAY OWNED BY GRANDVILLE CLARK, IN BEAUFORT COUNTY, NOT ALREADY WITHIN THE YEMASSEE TOWN LIMITS AND INCLUDING ALL ADJACENT PUBLIC RIGHTS OF WAY, RAILROAD RIGHTS OF WAY, WATERS, LOWLANDS AND WETLANDS.

Section 1. **Findings of Facts**

As an incident to the adoption of this ordinance, Town Council of Yemassee finds the following facts to exist:

- a) Section 5-3-150, Code of Laws of South Carolina (1976) as amended, provides a method of annexing property to a city or town by a Petition signed by all persons owning real estate in the area requesting annexation.
- b) A proper Petition has been filed with Town of Yemassee by one hundred percent (100%) of the freeholders owning one hundred percent (100%) of the assessed value of the contiguous property herein described, petitioning for annexation of the property to the Town of Yemassee under the provisions of South Carolina Section 5-3-150(3) and is requesting the Town's zoning of General Residential and have submitted proper submission materials supporting each application in accordance with Town requirements.
- c) It appears to Town Council that the annexation would be in the best interest of the property owners and the town.
- d) The Town Council is zoning the parcel General Residential.
- e) The Yemassee Town Council finds the proposed annexation and rezoning is consistent with the Yemassee Comprehensive Plan (as amended and revised);

Section 2.

NOW, THEREFOR IT BE ORDAINED by the Mayor and Council of the Town of Yemassee, South Carolina, duly assembled and with authority of the same, pursuant to Section 5-3-150 and Section 5-3-100, Code of Laws of South Carolina (1976), as amended, the following described property is hereby annexed to and made part of the Town of Yemassee, to wit:

ALL THOSE CERTAIN PIECES, PARCELS OR TRACTS OF LAND being known as R700 012 000 0051 0000 & 4.07 acres, and all adjacent public rights of ways and wetlands as shown on the attached map.

This Ordinance shall become effective upon ratification.

SO ORDERED AND ORDAINED THIS 8th Day of February, 2022

By the Yemassee Town Council being duly and lawfully assembled.



Colin Moore, Mayor

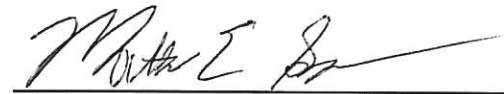

Matthew Barnes, Town Clerk

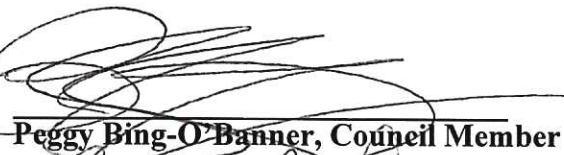

Peggy Bing-O'Banner, Council Member

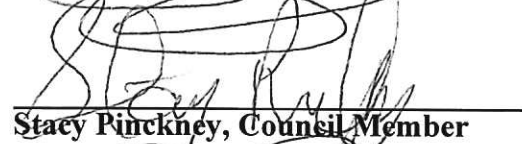

Stacy Pinckney, Council Member



David Paul Murray, Council Member

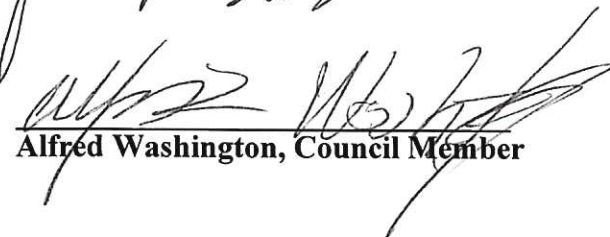

Alfred Washington, Council Member

(Seal)

First Reading: 2/1/22
Second Reading: 2/8/22



**PROPOSED
ANNEXATION
AREA**

Planned Unit
Development
Highway Corridor
Overlay District

Planned Unit
Development

Planned Unit
Development

R700.012.000
0051.0000

MONTGOMERY LN

BUCKFIELD RD

TRASK PKWY

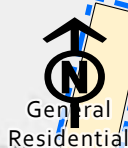

DEVEAUX HILL RD



South Carolina Department of Public Safety

OFFICE OF GENERAL COUNSEL

P.O. Box 1993 • Blythewood, S.C. 29016
Tel: (803) 896-7965 • Fax: (803) 896-7967

Town of Yemassee
FEB 22 2022
Received

February 17, 2022

Matthew E. Garnes
Town of Yemassee
P.O. Box 577
Yemassee, SC 29945

RE: Ordinance Nos. 22-01, 22-02, 22-03, 22-04, 22-05, and 22-06

Dear Mr. Garnes

Our office has received your notification of annexations into the Town of Yemassee through the above-referenced ordinances. By copy of this letter, I am forwarding the information to the Colonel of the South Carolina Highway Patrol for dissemination to appropriate staff.

Sincerely,

Marcus K. Gore
General Counsel

/mkg

cc: Col. Christopher N. Williamson

Town of Yemassee

Flood Zone Report - Beaufort

30 Jan 2022

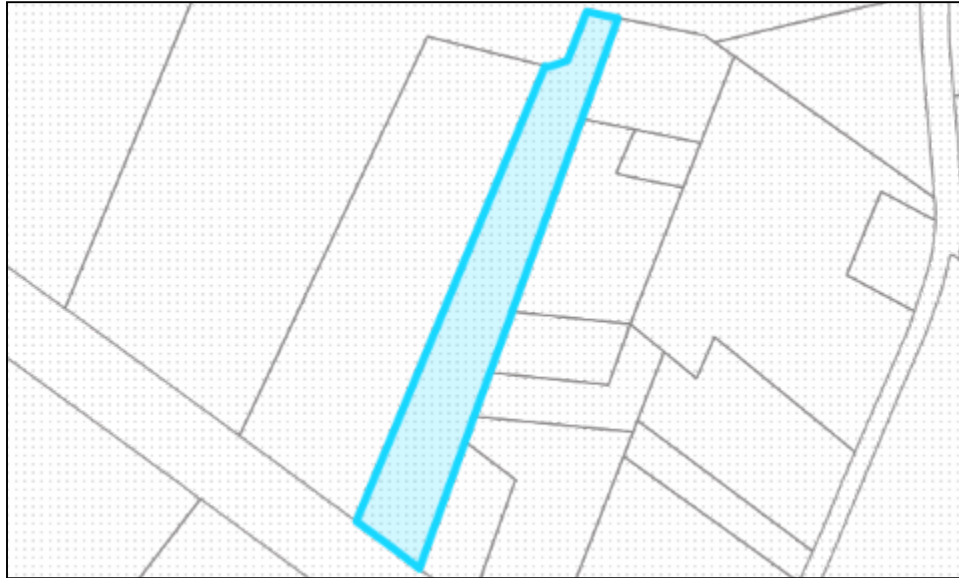

Parcels Beaufort

PIN:	R700 012 000 0051 0000
Owner City State ZIP Code:	YEMASSEE SC 29945
Owner:	CLARK JAMES E, CLARK GRANDVILLE
Owner Street Address:	133 TRASK PKY
Parcel Street Address:	127 TRASK PKWY

Flood Zones Beaufort

	Count	Classification	Overlapping Quantities
1.	1	Area of Minimal Flood Hazard	187,339.31sf (4.3acres)